

POS.	DIM.	A	B	C	D	POS.	DIM.	A	B	C	D
06P*	7.62	5.08	10.16	7.62	24P**	30.48	27.94	17.78	15.24		
08P*	10.16	7.62	10.16	7.62	28P**	35.56	33.02	17.78	15.24		
10P*	12.70	10.16	10.16	7.62	32P**	40.64	38.10	17.78	15.24		
12P*	15.24	12.70	10.16	7.62	36P	45.66	43.18	17.78	15.24		
14P*	17.78	15.24	10.16	7.62	40P**	50.80	48.26	17.78	15.24		
16P*	20.32	17.78	10.16	7.62	42P	53.34	50.80	17.78	15.24		
18P	22.86	20.32	10.16	7.62	48P	60.96	58.42	17.78	15.24		
20P	25.40	22.86	10.16	7.62							
22P	27.94	25.40	10.16	7.62							
24P	30.48	27.94	10.16	7.62							
28P	35.56	33.02	10.16	7.62							

* Without Bar ** Available With or Without Bar

APTOS Technology CONFIDENTIAL
 This document, and all information it contains, are the confidential, proprietary property of APTOS Technology. Disclosure, duplication or distribution of this document, or any information it contains, in whole or part, without prior written permission from APTOS Technology is strictly prohibited

SPECIFICATION

MATERIAL

Insulator: PBT, Rated UL94V-0

Contacts: Inner: Clip,beryllium Copper.

Outer: Brass

CONTACT PLATING

Inner:1.3μ"Gold

Outer:200μ"Tin

ELECTRICAL

Rating Current : 1 Amps Max.

Contact Resistance: 20 Milliohm Max

Insulation Resistance: 5000 Megohm Min @ 500 VDC

Dielectric Voltage: 500 VAC / 1 Minute

Operating Temperature: -25°C TO +85°C

PART NO.

MSIC E XX P XX X B A 0 3-G
 1 2 3 4 5 6 7 8 9 10 11

1.SERIES NO.

2.ENVIROMENTAL:

E=RoHS Material

3.CONTACT NUMBER:

06 TO 48

4.CONTACT TYPE:

P=Non Distribution

5.CONTACT PLATING:

VT=1.3u" Gold/Clip

200u" Tin Sleeve

VG=1.3u" Gold/Clip

1.2u" Gold Sleeve

VC=3u" Gold/Clip

3u" Gold Sleeve

6.ROW SPACING

A=2.54mmX7.62mm

B=2.54mmX15.24mm

7.TYPE OPTION:

B=Machined Pin Type

8.TYPE OPTION:

A=With Bar

B=W/O Bar

9.FILL IT WITH "0"

10.INSULATOR:

3=Black

11.ENVIRONMENTAL

G=RoHS Compliant

GENERAL TOLERANCE UNLESS OTHERWISE SPECIFIED		AP APTOS TECHNOLOGY	
XXX. ± X	.XX ± 0.2		
XX. ± X	.XXX ± X		
X. ± 0.5	X' ± 5'		
.X ± 0.3	.X' ± X'		
REV. E	DRAWN	03/08/10	MSIC Series
DATE 03/08/10	CHECKED		I.C. Socket – Machine Type
SCALE As shown	APPROVED		PRODUCT NO. MSICEXXPXXXBX03-G
UNIT mm		SIZE A4	FILE NAME: MSIC LF APD.DWG

SPECIFICATIONS

Electrical

Current Rating: 1 Amps
 Insulator Resistance: 5000 Megaohms min.
 Contact Resistance: 20 m ohms max.
 Dielectric withstanding: AC 500V
 Operating Temperature: -25°C~+85°C

Mechanical

Contact Material: Inner Clip: Beryllium Copper
 Outer: Brass
 Insulator Material: Nylon, UL 94V-0
 Finish: Inner: 1.3 μ" Gold
 Cover Material: Outer: 200 μ" Tin
 Color: Black
 Average Insertion Force: < 3
 W/Steel Pin Dia. 0.41mm:
 Average Withdrawal Force: > 0.4N
 W/Steel Pin Dia. 0.41mm:
 Mechanical Life Cycle: Min. 200

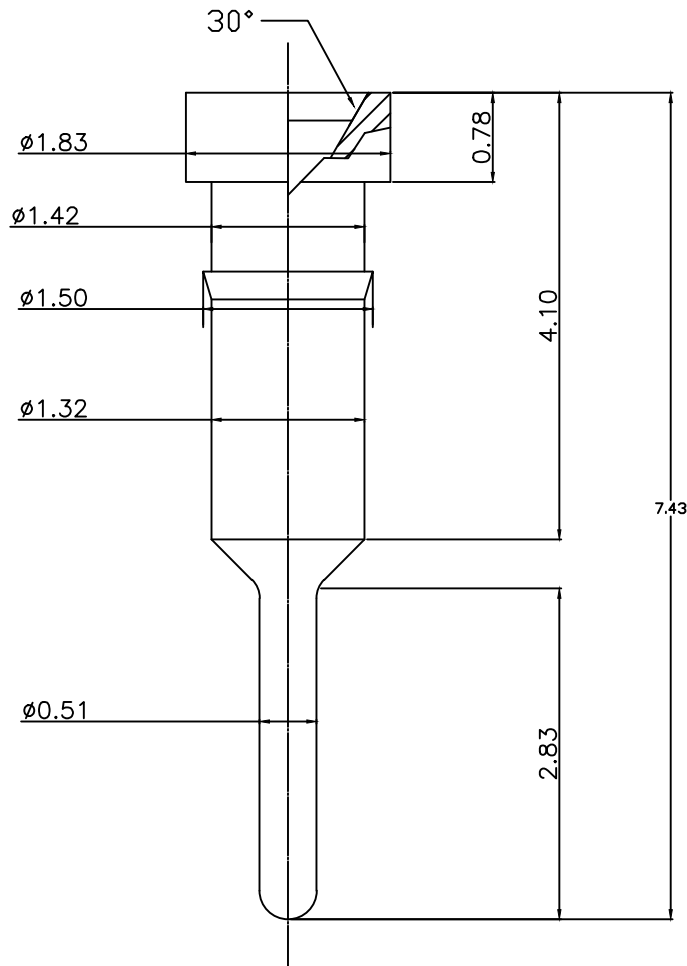

APTOS Technology CONFIDENTIAL
 This document, and all information it contains, are the confidential, proprietary property of APTOS Technology. Disclosure, duplication or distribution of this document, or any information it contains, in whole or part, without prior written permission from APTOS Technology is strictly prohibited

GENERAL TOLERANCE UNLESS OTHERWISE SPECIFIED	
XXX. ± X	.XX ± 0.2
XX. ± X	.XXX ± X
X. ± 0.5	X. ± 5'
.X ± 0.3	.X' ± X'
REV. D	DRAWN
DATE 10/02/06	CHECKED
SCALE As shown	APPROVED
UNIT mm	



12/19/05	MSIC Series
	I.C. Socket - Machine Type
	PRODUCT NO. MSICEXXPTXXX03
SIZE A4	FILE NAME: MSIC LF APD.DWG